

NOTES:

1. THE BASE MAP WAS COMPILED FROM THE FOLLOWING DATA:
  - 1.1. EXISTING TOPOGRAPHY PREPARED USING AERIAL PHOTOGRAMMETRIC TECHNIQUES ON PHOTOGRAPHY DATED JULY 23, 2016 FOR SOUTHBRIDGE RECYCLING & DISPOSAL PARK, INC. (SRDP) BY WSP OF CHARLTON, MASSACHUSETTS AND PROVIDED TO SANBORN, HEAD & ASSOCIATES, INC. (SANBORN HEAD) IN DIGITAL FORMAT. SCALE OF 1" = 40'.
  - 1.2. EXISTING TOPOGRAPHY PREPARED USING AERIAL PHOTOGRAMMETRIC TECHNIQUES ON PHOTOGRAPHY DATED JULY 5, 2017 FOR SOUTHBRIDGE RECYCLING & DISPOSAL PARK, INC. (SRDP) BY WSP OF CHARLTON, MASSACHUSETTS AND PROVIDED TO SANBORN, HEAD & ASSOCIATES, INC. (SANBORN HEAD) IN DIGITAL FORMAT ON JULY 25, 2017. SCALE OF 1" = 40'.
  - 1.3. EXISTING TOPOGRAPHY PREPARED USING AERIAL PHOTOGRAMMETRIC TECHNIQUES ON PHOTOGRAPHY DATED FEBRUARY 17, 2021 FOR SOUTHBRIDGE RECYCLING & DISPOSAL PARK, INC. (SRDP) BY AERIAL SURVEY & PHOTO, INC. OF NORRIDGEWOCK, MAINE AND PROVIDED TO SANBORN, HEAD & ASSOCIATES, INC. (SANBORN HEAD) IN DIGITAL FORMAT ON MARCH 2, 2021.
2. EXISTING LFG SYSTEM INFORMATION WAS TAKEN FROM THE FOLLOWING:
  - A. A PLAN TITLED "EXISTING GAS MANAGEMENT SYSTEM" PREPARED BY GEOSYNTEC DATED FEBRUARY 2013. THE PIPE LOCATIONS ARE BASED ON AN ON-THE-GROUND FIELD SURVEY PERFORMED BY CHAS. H. SELLS, INC. ON MAY 09, 2008 AND APPROXIMATE PIPE LOCATIONS DESCRIBED BY LANDFILL STAFF TO THE FIELD CREW.
  - B. AS-BUILT LOCATIONS FOR EXISTING LFG PIPING SHOWN WITHIN PHASE 7.3 STAGE I, WEST WERE PROVIDED TO SANBORN HEAD BY SOUTHBRIDGE RECYCLING & DISPOSAL PARK (SRDP) ON SEPTEMBER 19 AND OCTOBER 11, 2013.
  - C. LFG WELLS W-66 THROUGH W-70 WERE INSTALLED BY RECOVERY DRILLING SERVICES IN SEPTEMBER 2013. WELL LOCATIONS WERE PROVIDED BY SRDP.
  - D. AS-BUILT LFG PIPING INSTALLED IN LATE 2013 AND PROVIDED TO SANBORN HEAD BY BATES IN A FILE TITLED "20131125 SOUTHBRIDGE GAS ASBUILT" BASED ON SURVEY PERFORMED BY BATES FROM OCTOBER 28, 2013 TO NOVEMBER 8, 2013.
  - E. PHASE I-VI SYSTEM GAS WELL DESIGNATIONS ARE BASED ON LYNNFIELD ENGINEERING DRAWING "FIGURE 9 - GAS COLLECTION TREATMENT SYSTEM." EXISTING PHASE VII VERTICAL GAS WELL INFORMATION BASED ON AQUATERRA DRAWING "GAS EXTRACTION SYSTEM AS-BUILT SITE PLAN" DATED JANUARY 20, 2004 AND FROM CASELLA CONSTRUCTION, INC. INFORMATION (MARCH 2006 THROUGH JULY 2012).
  - F. LOCATIONS OF GCT-702 THROUGH GCT-703 ARE BASED ON AS-BUILT SURVEY DATA RECEIVED FROM SRDP OR BATES.
  - G. LFG WELLS W-76 THROUGH W-84 WERE INSTALLED BY RECOVERY DRILLING SERVICES IN MAY 2015. WELL LOCATIONS WERE PROVIDED BY SRDP.
  - H. AS-BUILT LFG PIPING INSTALLED IN MAY 2015 AND PROVIDED TO SANBORN HEAD BY WSP IN A FILE TITLED "B&M-SOUTHBRIDGE" BASED ON SURVEY PERFORMED BY WSP.
  - I. AS-BUILT LFG PIPING INSTALLED IN SEPTEMBER 2015 AND PROVIDED TO SANBORN HEAD BY CASELLA WASTE SYSTEMS, INC. (CASELLA) IN A FILE TITLED "7.4 As Builts" BASED ON SURVEY PERFORMED BY CASELLA.
  - J. AS-BUILT LFG PIPING INSTALLED IN OCTOBER 2015 AND PROVIDED TO SANBORN HEAD BY WSP IN A FILE TITLED "188025A-2-B&M-SOUTHBRIDGE" BASED ON SURVEY PERFORMED BY WSP.
  - K. AS-BUILT LFG PIPING INSTALLED IN NOVEMBER 2015 PROPOSED LOCATION SHOWN. SURVEY NOT TAKEN DURING CONSTRUCTION.
  - L. AS-BUILT LFG PIPING INSTALLED IN MARCH 2016 AND PROVIDED TO SANBORN HEAD BY CASELLA IN A FILE TITLED "7.4.2 Trench As-builts points (735&736).tp3" BASED ON SURVEY PERFORMED BY CASELLA.
  - M. AS-BUILT LFG PIPING INSTALLED IN APRIL 2016 AND PROVIDED TO SANBORN HEAD BY CASELLA IN A FILE TITLED "As Builts 7.4 Horizontals 20160422.tp3" BASED ON SURVEY PERFORMED BY CASELLA.
  - N. AS-BUILT LFG PIPING AND LFG WELLS WERE INSTALLED IN AUGUST 2016 AND PROVIDED TO SANBORN HEAD BY CASELLA IN A FILE TITLED "20160823 Riser Building Wells Revision W89" BASED ON SURVEY PERFORMED BY CASELLA.
  - O. AS-BUILT INFORMATION ON EAST SLOPE LFG IMPROVEMENTS IN 2016 IS BASED ON AS-BUILT SURVEY DATA RECEIVED FROM BATES.
  - P. AS-BUILT OF 2017 LFG WELLS BASED ON PROPOSED WELL LOCATIONS PREPARED BY SANBORN HEAD. VACUUM PIPING FOR WELLS PROVIDED TO SANBORN HEAD BY CASELLA BASED ON SURVEY PERFORMED BY CASELLA.
  - Q. AS-BUILT INFORMATION ON 7.3 WEST HEADER INSTALLATION IN 2017 IS BASED ON AS-BUILT SURVEY DATA RECEIVED FROM BATES ON MARCH 28, 2017.
  - R. LOCATIONS OF WELL HEADS SHOWN IN PHASE 7.4 STAGE II ARE APPROXIMATE.
  - S. LOCATIONS OF WELLS GW-99 THROUGH GW-112 BASED ON PROPOSED SURVEYED LOCATIONS AND ARE ESTIMATED TO BE REPRESENTATIVE OF AS-BUILT LOCATIONS.
  - T. AS-BUILT INFORMATION ON MAY/JUNE 2018 LFG INFRASTRUCTURE INSTALLATION IS BASED ON AS-BUILT SURVEY DATA RECEIVED FROM CHARTER CONTRACTING COMPANY, LLC ON JULY 16, 2018.
  - U. AS-BUILT INFORMATION OF OCTOBER 2018 WESTERN 18-INCH HEADER INSTALLATION IS BASED ON AS-BUILT SURVEY DATA RECEIVED FROM BATES ON OCTOBER 25, 2018.
  - V. LOCATIONS OF 2019 WELLS BASED ON PROPOSED LOCATIONS AND ARE ESTIMATED TO BE REPRESENTATIVE OF AS-BUILT LOCATIONS.
  - W. AS-BUILT INFORMATION OF THE 2019 GCCS MODIFICATIONS IS BASED ON SURVEY DATA RECEIVED FROM BATES ON NOVEMBER 13, 2019.
  - X. AS-BUILT INFORMATION OF THE 2020 GCCS MODIFICATIONS IS BASED ON SURVEY DATA RECEIVED FROM BATES ON DECEMBER 8, 2020.
3. EXISTING LFG SYSTEM INFORMATION IS BASED ON AS-BUILT SURVEY DATA AND FIELD OBSERVATIONS AS OF DECEMBER 8, 2020.
4. THE EXISTING UTILITIES SHOWN ON THIS PLAN REPRESENT A COMPILATION OF THE INFRASTRUCTURE NOTED ABOVE AND IS NOT INCLUSIVE OF ALL BELOW GRADE UTILITIES INSTALLED AT THE SITE.

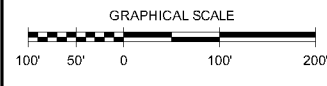
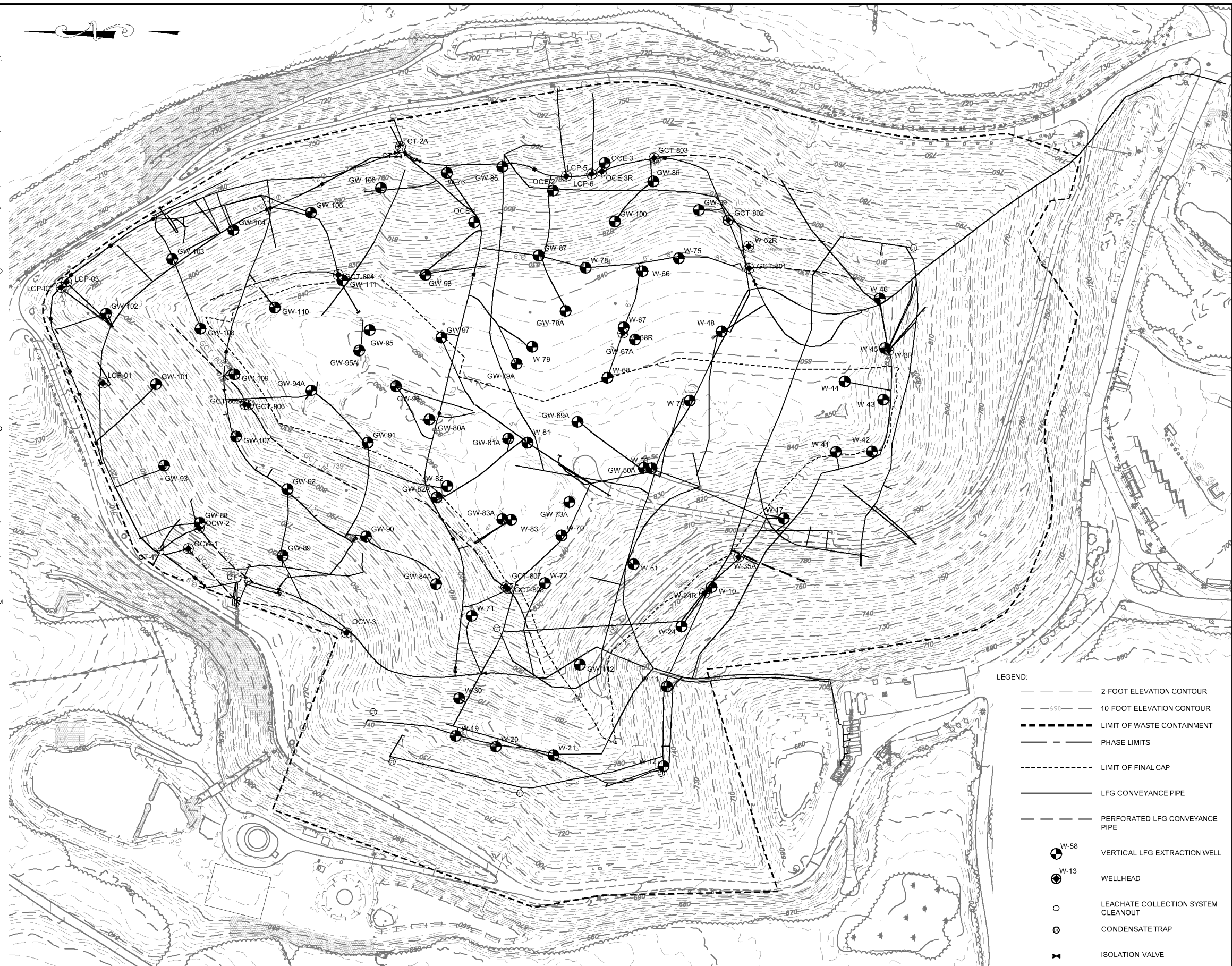

**DRAFT**

| NO. | DATE | DESCRIPTION | BY |
|-----|------|-------------|----|
|     |      |             |    |

DRAWN BY: D. LONG  
 DESIGNED BY: D. LONG  
 REVIEWED BY: S. WRIGHT  
 PROJECT MGR: D. LONG  
 PIC: D. ADAMS  
 DATE: APRIL 2021

**SOUTHBRIDGE RECYCLING & DISPOSAL PARK, INC.**  
 SOUTHBRIDGE, MASSACHUSETTS  
**GCCS EXISTING CONDITIONS  
 PROGRESS PLAN**

PROJECT NUMBER:  
 3530.69  
 SHEET NUMBER:  
 1 OF 1

SANBORN HEAD & ASSOCIATES, INC. 1000 STATE STREET, SUITE 200, BOSTON, MA 02116  
 PROJECT: SOUTHBRIDGE RECYCLING & DISPOSAL PARK, INC. (SRDP) - LFG INFRASTRUCTURE MODIFICATIONS  
 SHEET: LFG EXISTING CONDITIONS - PROGRESS PLAN  
 DATE: APRIL 2021